



HID-Basic ballasts for HPL and HPI(PLUS) lamps

BHLA 125L 200

The HID-Basic ballast is an impregnated (HID standard) electromagnetic ballast for HID lamps, for use in combination with an external ignitor.

Product data

General Information	
Application Code	L200
Operating and Electrical	
Input Voltage	220 V
Input Frequency	50 Hz
Power Factor 100% Load (Min)	0.55
Mains Voltage Performance (AC)	-8%~+6%
Mains Voltage Safety (AC)	-10%~+10%
Input Current with PF Correction	1.95 A
Input Current without PF Correction	2.18 A
Power Factor without PF Compensation (Nom)	0.85
Power Losses (Nom)	14.2 W
Wiring	
Connector Type	Screw
System characteristics	
Rated Ballast-Lamp Power	125 W

Temperature	
T-Winding (Max)	130 °C
Delta-T Normal Conditions	70 °C
Approval and Application	
Approval Marks	CE marking CCC certificate
Product Data	
Full product code	872790095590300
Order product name	BHLA 125L 200
EAN/UPC - Product	8711500999863
Order code	913713018659
Numerator - Quantity Per Pack	1
Numerator - Packs per outer box	6
Material Nr. (12NC)	913713018659
Net Weight (Piece)	1.250 kg

HID-Basic ballasts for HPL and HPI(PLUS) lamps

Dimensional drawing

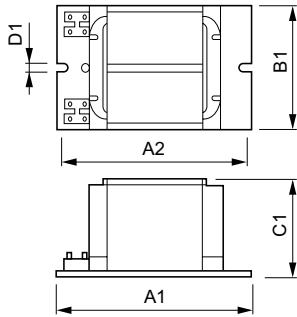

Product	D1	C1	A1	A2	B1
BHLA 125L 200	6.3 mm	64.5 mm	120.0 mm	100.0 mm	75.0 mm

BHLA 125 L200

