

# HID-Basic ballasts for HPL and HPI(PLUS) lamps

## BHLE 250L 202

The HID-Basic ballast is an impregnated (HID standard) electromagnetic ballast for HID lamps, for use in combination with an external ignitor.

### Product data

General Information		Temperature	
Application Code	L202	T-Winding (Max)	130 °C
		Delta-T Normal Conditions	70/75 °C
Operating and Electrical		Approval and Application	
Input Voltage	230 V	Approval Marks	CE marking
Input Frequency	50 Hz		
Power Factor 100% Load (Min)	0.85	Product Data	
Mains Voltage Performance (AC)	-8%~+6%	Full product code	872790084179400
Mains Voltage Safety (AC)	-10%~+10%	Order product name	BHLE 250L 202
Input Current with PF Correction	1.35 A	EAN/UPC - Product	8711500997906
Input Current without PF Correction	2.13/2.15 A	Order code	913713017550
Power Factor without PF Compensation (Nom)	0.60	Numerator - Quantity Per Pack	1
Power Losses (Nom)	21.6 W	Numerator - Packs per outer box	6
		Material Nr. (12NC)	913713017550
Wiring		Net Weight (Piece)	2.070 kg
Connector Type	Screw		
System characteristics			
Rated Ballast-Lamp Power	250 W		

## HID-Basic ballasts for HPL and HPI(PLUS) lamps

### Dimensional drawing

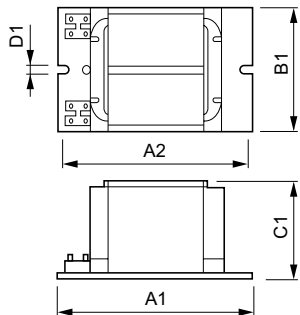

Product	D1	C1	A1	A2	B1
BHLE 250L 202	6.2 mm	64.5 mm	132.5 mm	119.0 mm	75.5 mm

BHLE 250 L202

