



# HID-Basic ballasts for HPL and HPI(PLUS) lamps

## BHL 250L 202

The HID-Basic ballast is an impregnated (HID standard) electromagnetic ballast for HID lamps, for use in combination with an external ignitor.

### Product data

General Information		Temperature	
Application Code	L202	T-Winding (Max)	130 °C
		Delta-T Normal Conditions	75 °C
Operating and Electrical		Approval and Application	
Input Voltage	230 V	Approval Marks	CE marking
Input Frequency	50 Hz	Product Data	
Power Factor 100% Load (Min)	0.55	Full product code	871016303125530
Mains Voltage Performance (AC)	-8%~+6%	Order product name	BHL 250L 202
Mains Voltage Safety (AC)	-10%~+10%	EAN/UPC - Product	8710163148304
Input Current with PF Correction	1.35 A	Order code	913710102550
Input Current without PF Correction	2.13/2.15 A	Numerator - Quantity Per Pack	1
Power Factor without PF Compensation (Nom)	0.85	Numerator - Packs per outer box	6
Power Losses (Nom)	20.4 W	Material Nr. (12NC)	913710102550
Wiring		Net Weight (Piece)	1.900 kg
Connector Type	Screw		
System characteristics			
Rated Ballast-Lamp Power	250 W		

## HID-Basic ballasts for HPL and HPI(PLUS) lamps

### Dimensional drawing

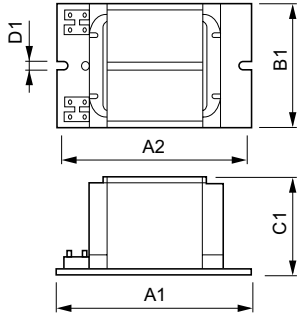

Product	D1	C1	A1	A2	B1
BHL 250L 202	6.3 mm	64.5 mm	125.0 mm	104.0 mm	72.5 mm

BHL 250 L202 230V 50Hz

