



Coreline tempo X-Large

BVP140 LED420-4S 36K1/740 PSD S D9

CORELINE TEMPO X-LARGE - LED module 42000 lm - 740 neutral white - Symmetrical

Coreline tempo X-Large delivers on the Coreline promise of innovative, easy to use and high quality luminaires; Designed to be a plug-and-play 1:1 retrofit of conventional floodlights with short payback time, its extensive options open a lot more opportunities to optimise performance and savings in many different applications, such as recreational sports facilities, industrial/commercial areas, car parks, etc.; This floodlight is equipped with the QR code-based Philips Service tag, which supports installation and maintenance work and enables you to create your digital library of lighting assets and spare parts.; As an option, Coreline tempo X-Large is also ready to be connected to lighting asset management systems, such as Interact City and Interact Sports recreational

Product data

General Information		Connection	
Lamp family code	LED420 [LED module 42000 lm]	Cable	Cable 1.0 m with plug Wieland/Adels compatible 5-pole
Light source colour	740 neutral white	Protection class IEC	Safety class I
Light source replaceable	Yes	Flammability mark	D [For mounting on easily flammable surfaces]
Number of gear units	2 units	CE mark	CE mark
Driver/power unit/transformer	PSD [Power supply unit with DALI interface]	ENEC mark	ENEC plus mark
Driver included	Yes	Warranty period	5 years
Optical cover/lens type	FG [Flat glass]	Optic type outdoor	Symmetrical
Luminaire light beam spread	73° x 26°		
Control interface	DALI		

Coreline tempo X-Large

Remarks	* At extreme ambient temperatures the luminaire might automatically dim down to protect components
Constant light output	No
Number of products on MCB (16 A type B)	4
EU RoHS compliant	Yes
LED engine type	LED
Serviceability class	Class C, luminaire without serviceable parts, not serviceable
Product family code	BVP140 [CORELINE TEMPO X-LARGE]

Light Technical

Upward light output ratio	0
Standard tilt angle post-top	0°
Standard tilt angle side entry	0°

Operating and Electrical

Input Voltage	220 to 240 V
Input frequency	50 to 60 Hz
Inrush current	53 A
Inrush time	0.3 ms
Power factor (min.)	0.99

Controls and Dimming

Dimmable	Yes
----------	-----

Mechanical and Housing

Housing material	Aluminium die-cast
Reflector material	-
Optic material	Acrylate
Optical cover/lens material	Glass
Fixation material	Steel
Mounting device	MBA [Mounting bracket adjustable]
Optical cover/lens shape	Flat
Optical cover/lens finish	Clear
Overall length	540 mm
Overall width	560 mm
Overall height	70 mm
Effective projected area	0.26 m ²
Colour	Grey
Dimensions (height x width x depth)	70 x 560 x 540 mm (2.8 x 22 x 21.3 in)

Approval and Application

Ingress protection code	IP66 [Dust penetration-protected, jet-proof]
-------------------------	---

Mech. impact protection code	IK08 [5 J vandal-protected]
Surge protection (common/differential)	-

Initial Performance (IEC Compliant)

Initial luminous flux	36120 lm
Luminous flux tolerance	+/-7%
Initial LED luminaire efficacy	144 lm/W
Init. Corr. Colour Temperature	4000 K
Init. Colour rendering index	>70
Initial chromaticity	(0.38, 0.38) SDCM <5
Initial input power	250 W
Power consumption tolerance	+/-11%

Over Time Performance (IEC Compliant)

Control gear failure rate at median useful life 75,000 h	7.6 %
Control gear failure rate at median useful life 100,000 h	10 %
Lumen maintenance at median useful life* 75,000 h	L90
Lumen maintenance at median useful life* 100,000 h	L96

Application Conditions

Ambient temperature range	-40 to +50 °C
Performance ambient temperature Tq	25 °C
Maximum dimming level	10%

Product Data

Full product code	871869987291500
Order product name	BVP140 LED420-4S 36K1/740 PSD S D9
EAN/UPC – product	8718699872915
Order code	87291500
Numerator – quantity per pack	1
SAP numerator – packs per outer box	1
Material no. (12 NC)	912300024347
SAP net weight (piece)	17.010 kg



Coreline tempo X-Large

Dimensional drawing

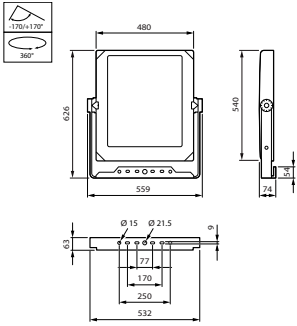

CoreLine Tempo BVP110/120/125/130/140

Photometric data

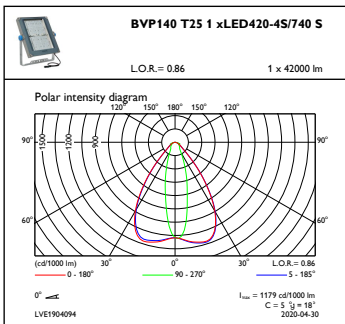

OFPC1_BVP140T251xLED420-4S740S

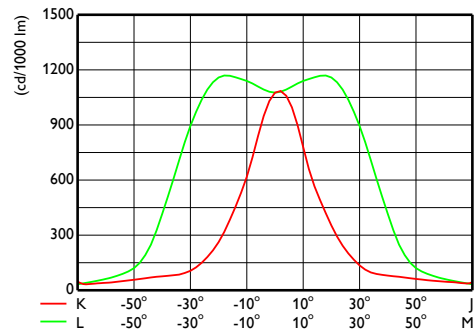

OFCS1_BVP140T251xLED420-4S740S

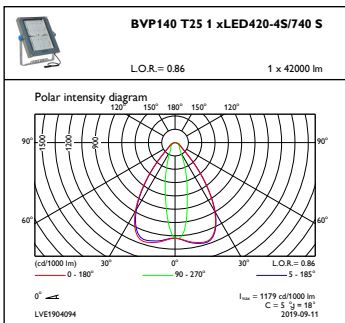

OFPC1_BVP140T251xLED420-4S740S

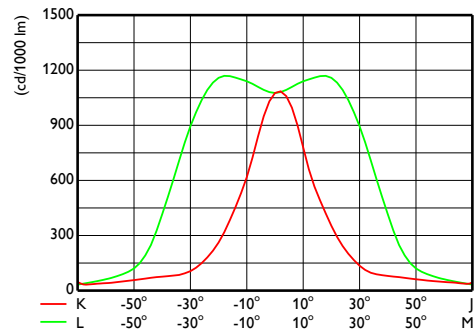

OFCS1_BVP140T251xLED420-4S740S

Coreline tempo X-Large

