

# HID-Basic Semi-Parallel ballasts for MHN/CDM lamps

## BMH 70L 300I TS

The HID Basic Semi-Parallel ballast is an impregnated (HID standard) electromagnetic copper/iron ballast for use with an external ignitor for metal-halide and CDM lamps.

### Product data

Operating and Electrical		Full product name	
Input Voltage	220 V	Full product name	BMH 70L 300I TS
Line Frequency	50 Hz	Full product code	697480505105200
Input Frequency	50 Hz	Order code	913713200667
		Material Nr. (12NC)	913713200667
		Numerator - Quantity Per Pack	1
		Net Weight (Piece)	1.060 kg
		EAN/UPC - Product/Case	6974805051052
		Numerator - Packs per outer box	6
		EAN/UPC - Case	6974805051069
Wiring			
Connector Type	Screw		
Approval and Application			
Approval Marks	CE marking ENEC certificate CCC certificate		
Product Data			
Order product name	BMH 70L 300I TS		

## HID-Basic Semi-Parallel ballasts for MHN/CDM lamps

### Dimensional drawing

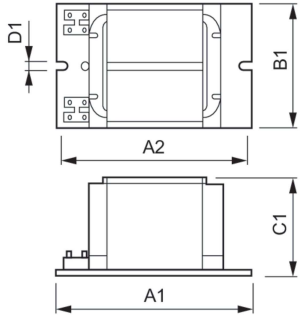

Product	D1	C1	A1	A2	B1
BMH 70L 300I TS	6.2 mm	51.5 mm	117.0 mm	102.0 mm	57.1 mm

