



Other LEDtube



LED 4.5W 310mm S19 WW ND 1CT/4

Philips LEDtube integrates a LED light source into a traditional fluorescent form factor. This product is the ideal solution for uplampping in general lighting applications: it meets basic lighting requirements, offers significant energy savings, and is environmentally friendly.

Product data

General Information	
Cap-Base	S19 [S19]
EU RoHS compliant	Yes
Nominal Lifetime (Nom)	30000 h
Switching Cycle	50000X
Technical Type	4.5-60W
Flux measurement reference	Sphere
Light Technical	
Color Code	827 [CCT of 2700K]
Beam Angle (Nom)	175 °
Luminous Flux (Nom)	480 lm
Color Designation	Warm White (WW)
Correlated Color Temperature (Nom)	2700 K
Luminous Efficacy (rated) (Nom)	106.00 lm/W
Color Consistency	<6
Color Rendering Index (Nom)	80
LLMF At End Of Nominal Lifetime (Nom)	70 %
Operating and Electrical	
Input Frequency	50 to 60 Hz
Power (Nom)	4.5 W
Lamp Current (Nom)	40 mA

Starting Time (Nom)	0.5 s
Warm Up Time to 60% Light (Nom)	0.5 s
Power Factor (Nom)	0.5
Voltage (Nom)	220-240 V
Temperature	
T-Ambient (Max)	45 °C
T-Ambient (Min)	-20 °C
T-Storage (Max)	65 °C
T-Storage (Min)	-40 °C
T-Case Maximum (Nom)	30 °C
Controls and Dimming	
Dimmable	No
Mechanical and Housing	
Bulb Finish	Frosted
Bulb Material	Plastic
Product Length	300 mm
Bulb Shape	Others
Approval and Application	
Energy Efficiency Class	F

Other LEDtube

Energy Saving Product	Yes
Approval Marks	RoHS compliance CE marking KEMA Keur certificate
Energy Consumption kWh/1000 h	5 kWh
EPREL Registration Number	387346

Product Data

Full product code	871951426360400
Order product name	LED 4.5W 310mm S19 WW ND 1CT/4

EAN/UPC - Product	8719514263604
Order code	929002443801
Numerator - Quantity Per Pack	1
Numerator - Packs per outer box	4
Material Nr. (12NC)	929002443801
Net Weight (Piece)	0.076 kg

Dimensional drawing

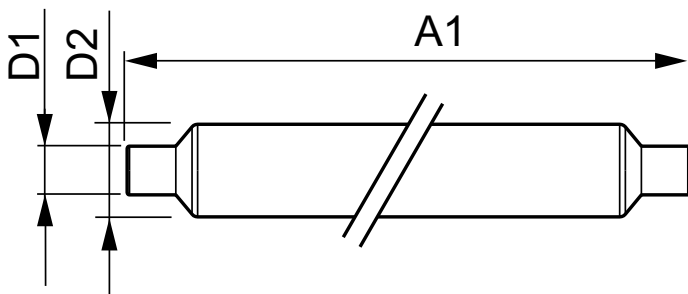

LED 220-240V 4.5-60W 480lm 2700K S19

Product	D1	D2	A1	A2	A3
LED 4.5W 310mm S19 WW ND 1CT/4	38 mm	38 mm	273.6 mm		310 mm

Photometric data

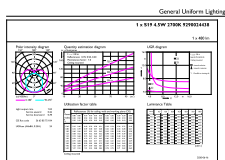

OSRAM Powerline S19 Philips Lighting BV Page 11

LEDtube 4,5W S19 480lm 827

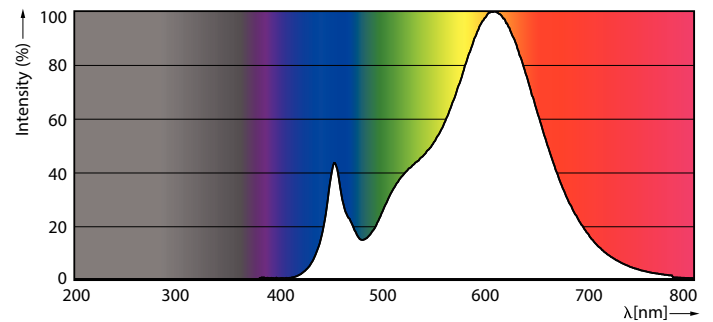

LEDtube 4,5W S19 480lm 827

Other LEDtube

Photometric data

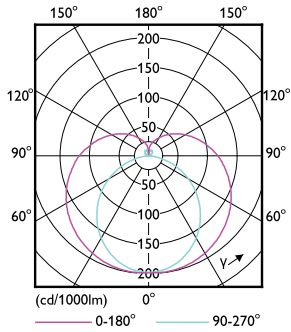

LEDtube 4,5W S19 480lm

Lifetime

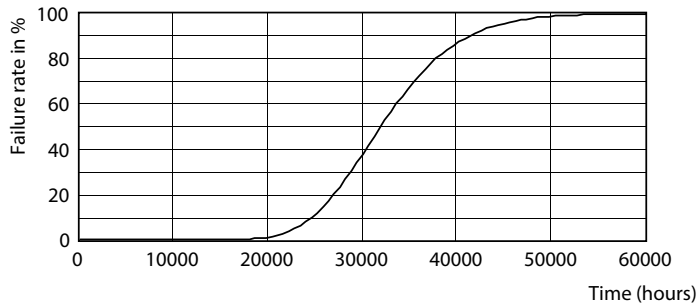

LEDtube 30K

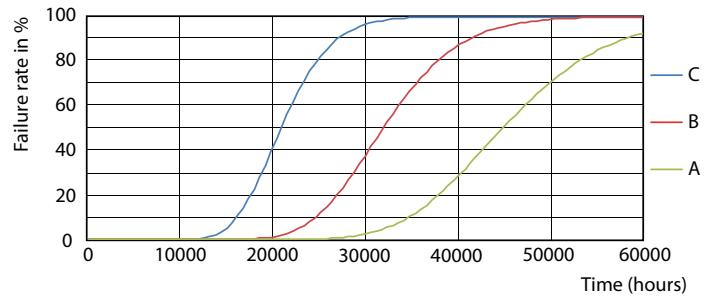

LEDtube 30K FailureRate

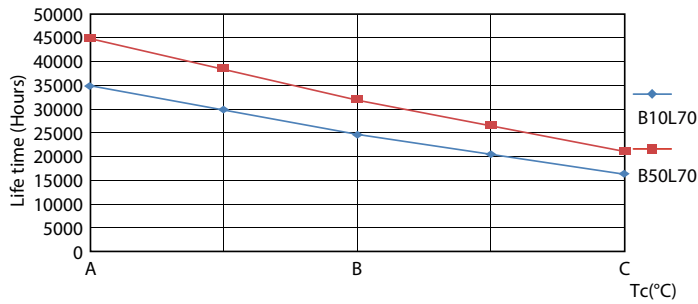

LEDtube 30K LifetimeVsTc

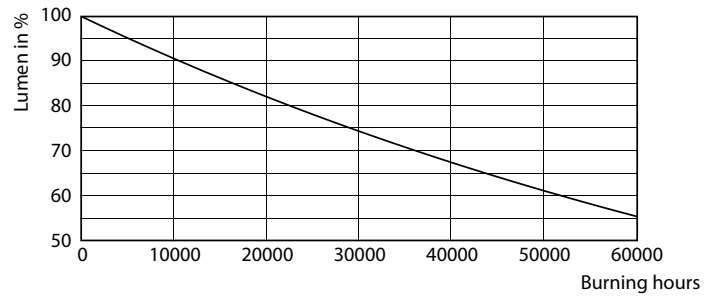

LEDtube 30K

Other LEDtube

Lifetime

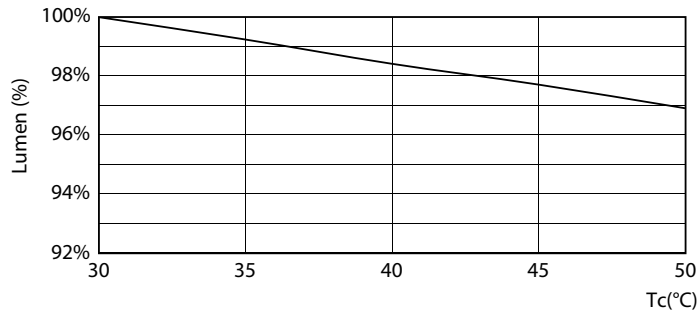

LEDtube S14 30K LumenVsTc

