



# EB-Certalume for PLT/C lamps

## EB-C 213 PL-T/C 220-240V 50/60Hz

Affordable, reliable, high frequency electronic ballast for 4-pin PL-T and PL-C fluorescent lamps, ideal alternative for electromagnetic (EM) ballasts; The ballast is primarily designed for Indoor application. For outdoor application, the luminaire should be minimum Classland need to be sufficiently protected against water & dust. The installation should also be guard against any lightening surge or any other necessary electrical protection as deemed in such typical installation & application.

### Product data

General Information	
Type Version	mk1
Lamp Type	PL-T/C
Number of Lamps	2 piece/unit
Number of Products on MCB (16A Type B) (Nom)	20
Automatic Restart	No
Operating and Electrical	
Input Voltage	220 to 240 V
Input Frequency	50 to 60 Hz
Operating Frequency (Nom)	20-40 kHz
Crestfactor (Nom)	1.9
Power Factor 100% Load (Nom)	0.95
Mains Voltage Safety (AC)	-10%~+10%
Earth Leakage Current (Nom)	0.5 mA

Wiring	
Connector Type Input Terminals	250 manual connector [ Suitable for manual wiring and easy release button]
Cable Capacity Output Wires Mutual (Max)	120 pF
Color Input Terminals	Orange
Color Output Terminals	Grey
Connector Type Output Terminals	250 manual connector [ Suitable for manual wiring and easy release button]
Cable Length Hot Wiring	0.75 m
Wire Striplength	9.0-10.0 mm
Dual Fixture Master/Slave	Not advisable [ Master/Slave operation not advised]
Input Terminal Cross Section	0.50-1.50 mm <sup>2</sup>
Output Terminal Cross Section	0.50-1.50 mm <sup>2</sup>
Cable Capacity Output Wires to Earth (Max)	120 pF
System characteristics	
Rated Ballast-Lamp Power	13 W
System Power on PL-T/C	30.0 W

## EB-Certalume for PLT/C lamps

Power Loss on PL-T/C	4.0 W
Lamp Power on PL-T/C	13.0 W

### Temperature

T-Case Lifetime (Nom)	65 °C
T-Case Maximum (Max)	65 °C

### Mechanical and Housing

Housing	- [ Not Specified]
---------	--------------------

### Emergency Operation

Battery Voltage Lamp Ignition	165-253 V
-------------------------------	-----------

### Approval and Application

Energy Efficiency Index	A2
IP Classification	IP 20 [ Ingress Protection 20]
Overvoltage Protection 276Vac	48 h

EMI 9 kHz ... 30 MHz	EN55015
Vibration Standard	IEC68-2-6 F c
Bumps Standard	IEC 68-2-29 Eb
Humidity Standard	IEC 61347-2-3
Approval Marks	CCC certificate CB Certificate

### Product Data

Full product code	872790083287700
Order product name	EB-C 213 PL-T/C 220-240V 50/60Hz
EAN/UPC - Product	8711500997739
Order code	913713198514
Numerator - Quantity Per Pack	1
Numerator - Packs per outer box	24
Material Nr. (12NC)	913713198514
Net Weight (Piece)	0.128 kg

## Dimensional drawing

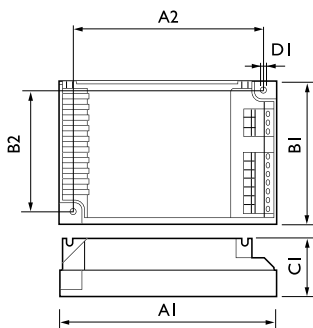

EB-C 213 PL-T/C 220-240V 50/60Hz

Product	D1	C1	A1	A2	B1
EB-C 213 PL-T/C 220-240V 50/60Hz	4.2 mm	31.0 mm	94.0 mm	86.0 mm	72.0 mm

