



HF-Selectalume II for TL5 lamps

HF-S 149 TL5 II 220-240V 50/60Hz

HF-Selectalume II TL5 is the most cost-effective, reliable and outstanding solution for fluorescent lamps. These ballasts are part of an overall high-efficiency lighting system that may help you or your customers to achieve any international or local energy code you need to comply with. HF-Selectalume II TL5 ballasts are the ideal choice for a broad range of new construction and retrofit applications within the commercial sector, including general surface mounting or office lighting, parking garages, warehouses, waterproof and other applications. The ballast is primarily designed for Indoor application. For outdoor application, the luminaire should be minimum Classland need to be sufficiently protected against water & dust. The installation should also be guard against any lightening surge or any other necessary electrical protection as deemed in such typical installation & application.

Product data

General information		Mains Voltage Performance (AC)	
Application Code	II	Mains Voltage Performance (AC)	202-254V-8%~+6%
Type Version	mk1	Mains Voltage Safety (AC)	198-264V-10%~+10%
Lamp Type	TL5	Earth Leakage Current (Max)	0.5 mA
Number of Lamps	1 piece/unit	Inrush Current Width	0.25 ms
Automatic Restart	Yes	Ballast Factor (Nom)	1.05
Operating and electrical		Power Losses (Nom)	4.2 W
Input Voltage	220 to 240 V	Inrush Current Peak (Max)	20 A
Input Frequency	50 to 60 Hz	Efficiency at full load [%]	93.6 %
Operating Frequency (Nom)	40-60 kHz	Wiring	
Crestfactor (Nom)	1.7	Connector Type Input Terminals	WAGO 744 connector
Power Factor 100% Load (Nom)	0.97	Cable Capacity Output Wires Mutual (Max)	200 pF
Preheat Time	1.21 s	Connector Type Output Terminals	WAGO 744 connector [Suitable for manual wiring]

HF-Selectalume II for TL5 lamps

Cable Length Hot Wiring	0.75 m
Wire Striplength	8.0-9.0 mm
Dual Fixture Master/Slave	Possible, lamp wires 2m max. length [Master/Slave operation possible]
Input Terminal Cross Section	0.50-1.50 mm ²
Output Terminal Cross Section	0.50-1.50 mm ²
Cable Capacity Cold Output Wires - Earth (Max)	200 pF
Cable Capacity Hot Output Wires - Earth (Max)	200 pF

System characteristics

Rated Ballast-Lamp Power	49 W
Rated Lamp Power on TL5	49 W
System Power on TL5	55.2 W
Lamp Power on TL5	51 W
Power Loss on TL5	4.2 W

Temperature

T-Ambient (Max)	50 °C
T-Ambient (Min)	-15 °C
T-Storage (Max)	80 °C
T-Storage (Min)	-40 °C
T-Case Lifetime (Nom)	75 °C
T-Case Maximum (Max)	75 °C

Mechanical and housing

Housing	L 280x30x21
---------	-------------

Emergency operation

Nominal Light Output After 60 Seconds	100% of EBLF
Normal Operating Voltage (DC)	220-240 V

Battery Voltage Guaranteed Operation	176-275 V
Battery Voltage Guaranteed Ignition	186-275 V
Emergency Ballast Lumen Factor (EBLF) (Nom)	100 %
Nominal Light Output After 5 Seconds	50% of EBLF

Approval and application

Energy Efficiency Index	A2 BAT
IP Classification	IP20 [Finger-protected]
EMI 9 kHz ... 30 MHz	EN55015
Vibration Standard	IEC68-2-6 F c
Bumps Standard	IEC 68-2-29 Eb (10G/16ms)
Approval Marks	F-Marking CE marking ENEC certificate CCC certificate C-Tick certificate PSB certification TISI marking SIRIM approval CB Certificate CCC certificate VDE-EMV certificate
Hum And Noise Level	< 30 dB(A)

Product data

Full product code	872790090558800
Order product name	HF-S 149 TL5 II 220-240V 50/60Hz
EAN/UPC - Product	8711500999351
Order code	913713033466
Numerator - Quantity Per Pack	1
Local code description	HF-S 149 TL5 II CCC
Numerator - Packs per outer box	12
Material Nr. (12NC)	913713033466
Net Weight (Piece)	0.185 kg

Dimensional drawing

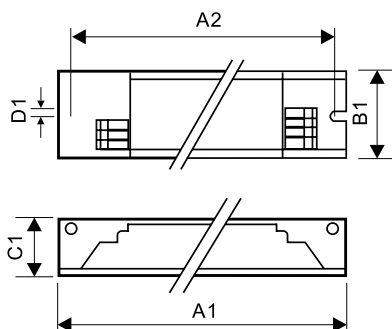

HF-S 149 TL5 II 220-240V 50/60Hz

Product

HF-S 149 TL5 II 220-240V 50/60Hz

HF-Selectalume II for TL5 lamps

