



HID-Basic ballasts for HPL and HPI(PLUS) lamps

BHLE 400L 200 TS

The HID-Basic ballast is an impregnated (HID standard) electromagnetic ballast for HID lamps, for use in combination with an external ignitor.

Product data

| General Information | |
|--|-------------|
| Application Code | L200 TS |
| Operating and Electrical | |
| Input Voltage | 220 V |
| Input Frequency | 50 Hz |
| Power Factor 100% Load (Min) | 0.85 |
| Mains Voltage Performance (AC) | -8%~+6% |
| Mains Voltage Safety (AC) | -10%~+10% |
| Input Current with PF Correction | 2.15 A |
| Input Current without PF Correction | 3.25/3.4 A |
| Power Factor without PF Compensation (Nom) | 0.60 |
| Power Losses (Nom) | 25.5/27.5 W |
| Wiring | |
| Connector Type | Screw |
| System characteristics | |
| Rated Ballast-Lamp Power | 400 W |

| Temperature | |
|---------------------------------|------------------|
| T-Winding (Max) | 130 °C |
| Delta-T Normal Conditions | 70/75 °C |
| Approval and Application | |
| Approval Marks | CE marking |
| Product Data | |
| Full product code | 697480505031400 |
| Order product name | BHLE 400L 200 TS |
| EAN/UPC - Product | 6974805050314 |
| Order code | 913713017342 |
| Numerator - Quantity Per Pack | 1 |
| Numerator - Packs per outer box | 6 |
| Material Nr. (12NC) | 913713017342 |
| Net Weight (Piece) | 2.900 kg |

HID-Basic ballasts for HPL and HPI(PLUS) lamps

Dimensional drawing

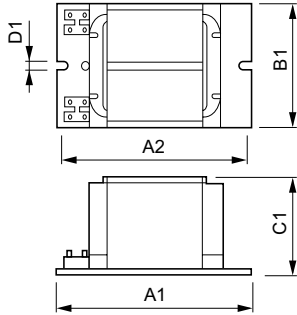

| Product | D1 | C1 | A1 | A2 | B1 |
|------------------|--------|---------|----------|----------|---------|
| BHLE 400L 200 TS | 6.2 mm | 64.5 mm | 165.0 mm | 144.0 mm | 75.5 mm |

BHLA 400 L200 TS

