



# HID-Basic ballasts for HPL and HPI(PLUS) lamps

## BPI 250L 200 TS

The HID-Basic ballast is an impregnated (HID standard) electromagnetic ballast for HID lamps, for use in combination with an external ignitor.

### Product data

| General Information                        |             |
|--|-------------|
| Application Code                           | L200 TS     |
| Operating and Electrical                   |             |
| Input Voltage                              | 220 V       |
| Input Frequency                            | 50 Hz       |
| Power Factor 100% Load (Min)               | 0.85        |
| Mains Voltage Performance (AC)             | -8%~+6%     |
| Mains Voltage Safety (AC)                  | -10%~+10%   |
| Input Current with PF Correction           | 1.35 A      |
| Input Current without PF Correction        | 2.13/2.15 A |
| Power Factor without PF Compensation (Nom) | 0.55        |
| Power Losses (Nom)                         | 17.5 W      |
| Wiring                                     |             |
| Connector Type                             | Screw       |
| System characteristics                     |             |
| Rated Ballast-Lamp Power                   | 250 W       |

| Temperature                     |                            |
|---------------------------------|----------------------------|
| T-Winding (Max)                 | 130 °C                     |
| Delta-T Normal Conditions       | 65 °C                      |
| Approval and Application        |                            |
| Approval Marks                  | CE marking CCC certificate |
| Product Data                    |                            |
| Full product code               | 694818229959800            |
| Order product name              | BPI 250L 200 TS            |
| EAN/UPC - Product               | 6948182295828              |
| Order code                      | 913713016642               |
| Numerator - Quantity Per Pack   | 1                          |
| Numerator - Packs per outer box | 6                          |
| Material Nr. (12NC)             | 913713016642               |
| Net Weight (Piece)              | 2.100 kg                   |

## HID-Basic ballasts for HPL and HPI(PLUS) lamps

### Dimensional drawing

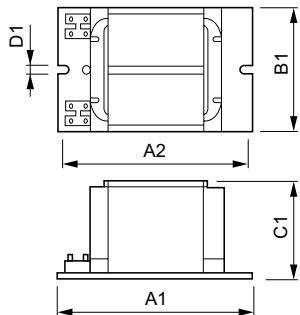

| Product         | D1     | C1      | A1     | A2     | B1      |
|-----------------|--------|---------|--------|--------|---------|
| BPI 250L 200 TS | 6.2 mm | 64.5 mm | 125 mm | 110 mm | 72.5 mm |

BPI 250 L200 TS

