

PHILIPS

Lighting



HID-GreenVision GP-SON

HID-GVIII 750W/P GP-SON 400V NA

Full electronic driver for GP-SON 600/1000W lamps

Product data

General Information	
Application Code	400V
Type Version	NA
Lamp Type	GP-SON
Number of Lamps	1 piece/unit
Suitable For Outdoor Use	Yes
Automatic Restart	No
Operating and Electrical	
Input Voltage	400 V
Input Frequency	50 to 60 Hz
Minimum Mains Voltage Operation (Min)	270 V
Operating Frequency (Nom)	220 kHz
Power Factor 100% Load (Nom)	0.99
Ignition Voltage (Max)	2.5 kV
Ignition Voltage (Min)	2.3 kV
Ignition Switch-Off Time (Nom)	5 min
Mains Voltage Performance (AC)	270-424V
Mains Voltage Safety (AC)	249-440V
Output Peak Voltage (Max)	3200 V
Inrush Current Width	1.6 ms
Inrush Current Peak (Max)	30 A

Wiring	
Cable Capacity Output Wires Mutual (Nom)	250 pF
Connector Type	JST VH-B Connector
System characteristics	
Rated Ballast-Lamp Power	750W/P
Temperature	
T-Ambient (Max)	35 °C
T-Ambient (Min)	0 °C
T-Storage (Max)	85 °C
T-Storage (Min)	-20 °C
T-Case Lifetime (Nom)	70 °C
T-Case Switch Off (Min)	110 °C
Controls and Dimming	
Control Interface	None
Mechanical and Housing	
Housing	L 181x151x58
Approval and Application	
Energy Efficiency Index	A2

HID-GreenVision GP-SON

Surge Protection (Common/Differential)	EN61547 5.7 kV
IP Classification Luminaire	65
Active Temperature Protection	Yes
EMI 9 kHz ... 300 MHz	FCC title 47 Part 18 (Class A)
Safety Standard	EN60928, 60926
Quality Standard	ISO 9000:2000
Environmental Standard	ISO 14001
Harmonic Current Emission Standard	EN 61000-3-2
Vibration Standard	EN60068-2-6 F c
Bumps Standard	EN 60068-2-29 Eb
Approval Marks	CSA certificate UL certificate
Hum And Noise Level	< 45 dB(A)

Product Data

Full product code	871869664627400
Order product name	HID-GVIII 750W/P GP-SON 400V NA
EAN/UPC - Product	8718696646274
Order code	913712009361
Numerator - Quantity Per Pack	1
Numerator - Packs per outer box	144
Material Nr. (12NC)	913712009361
Net Weight (Piece)	0.760 kg

Dimensional drawing

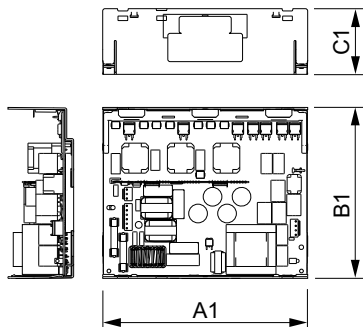

HID-GVIII 750W/P GP-SON 400V NA

Product	A1	B1	C1
HID-GVIII 750W/P GP-SON 400V NA	181 mm	151 mm	58 mm

