



PrimaVision BasePerform

HID-PV Base HID-PV Base 50 SON C3 220-240V

Highly reliable electronic drivers for SON and CDO lamps designed to save energy thanks to better light efficiency compared to magnetic drivers, and to save on maintenance costs thanks to a lifetime of up to 50,000 hours.

Product data

General information	
Lamp Type	SON/CDO
Number of Lamps	1 piece/unit
Suitable For Outdoor Use	Yes
Number of Products on MCB (16A Type B) (Nom)	17
Default Lamp Selected	SON/CDO 50
Automatic Restart	No

Operating and electrical	
Input Voltage	220 to 240 V
Input Frequency	50 to 60 Hz
Minimum Mains Voltage Operation (Min)	172 V
Operating Frequency (Nom)	0.145 kHz
Power Factor 100% Load (Nom)	0.95
Ignition Time (Max)	30 s
Ignition Time (Nom)	10 s
Ignition Voltage (Max)	2.5 kV
Ignition Switch-Off Time (Nom)	20 min
Mains Voltage Performance (AC)	198-254V
Mains Voltage Safety (AC)	180-264V

Earth Leakage Current (Max)	0.7 mA
Output Peak Voltage (Max)	250 V
Inrush Current Width	0.25 ms
Lamp Power Tolerance	-5%/+5%
Input Current (Nom)	0.26 A
Inrush Current Peak (Max)	28 A
Rated Lamp Power	50 W
Efficiency at full load [%]	90.73 %

Wiring	
Cable Capacity Output Wires Mutual (Max)	150 pF
Cable Length From Device to Lamp	1.5 m
Wire Striplength	10.0-11.0 mm
Ballast Contact Wire Cross Section	0.50-2.50 mm ²
Connector Type	WAGO series 804

System characteristics	
Rated Ballast-Lamp Power	56 W
Rated Lamp Power on CDO	50 W
System Power on CDO	56 W
Lamp Power on CDO	50 W

PrimaVision BasePerform

Power Loss on CDO	6 W
Rated Lamp Power on Son	50 W
System Power on Son	56 W
Lamp Power on Son	50 W
Power Loss on Son	6 W

Temperature

T-Ambient (Max)	55 °C
T-Ambient (Min)	-30 °C
T-Storage (Max)	55 °C
T-Storage (Min)	-30 °C
T-Case Lifetime (Nom)	80 °C
T-Case Switch Off (Min)	90 °C

Controls and dimming

Programmable Lamp Settings	None
Pre-Set Integrated Controls	None
Programmable Dimming Options	None
Control Input Protection	Yes (Basic insulation)

Mechanical and housing

Housing	C3
---------	----

Approval and application

Surge Protection (Common/Differential)	EN61547 (L-L 2kV, L-G 4kV) kV
IP Classification Luminaire	20
Active Temperature Protection	Yes
EMI 9 kHz ... 300 MHz	CISPR 15 ed 7.2

EMI 30 MHz ... 1000 MHz	CISPR15 Edition 7.2
Safety Standard	IEC 607, 609, 926, 928 [No Standard for HID Lamp drivers exists. Requirements in these standards to be used if considered relevant for the product.]
Quality Standard	ISO 9000:2000
Environmental Standard	ISO 14001
Harmonic Current Emission Standard	IEC 61000-3-2
Vibration Standard	IEC 68-2-6 Fc (10-150Hz, 2G)
Bumps Standard	IEC 68-2-29 Eb (10G/16ms)
Humidity Standard	EN 61347-2-12 clause 11
Approval Marks	CE marking ENEC certificate VDE-EMV certificate
Hum And Noise Level	< 30 dB(A)

Product data

Full product code	871869653147100
Order product name	HID-PV Base HID-PV Base 50 SON C3 220-240V
EAN/UPC - Product	8718696531471
Order code	913712008666
Numerator - Quantity Per Pack	1
Numerator - Packs per outer box	12
Material Nr. (12NC)	913712008666
Net Weight (Piece)	0.230 kg

Dimensional drawing

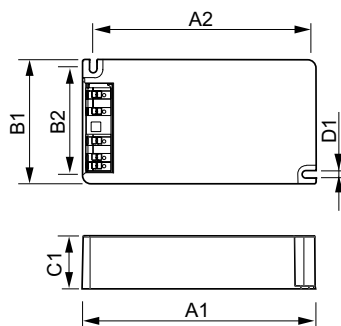

HID-PV Base HID-PV Base 50 SON C3 220-240V

Product	D1	C1	A1	A2	B1	B2
HID-PV Base HID-PV	4.5 mm	32.0	141.0	128.5	75.0	63.7
Base 50 SON C3		mm	mm	mm	mm	mm
220-240V						

PrimaVision BasePerform

