

# HID-High Power ballasts for MH lamps

## BMH 2000L 2050

The HID High-Power ballast is an impregnated (HID standard) electromagnetic copper/iron ballast for use with an external ignitor for HID lamps.

### Product data

General Information	
Application Code	L2050
Operating and Electrical	
Input Voltage	400 V
Input Frequency	50 Hz
Power Factor 100% Load (Min)	0.85
Mains Voltage Performance (AC)	-8%~+6%
Mains Voltage Safety (AC)	-10%~+10%
Input Current with PF Correction	5.4 A
Input Current without PF Correction	9.6/10.3 A
Power Factor without PF Compensation (Max)	0.50
Power Factor without PF Compensation (Min)	0.40
Power Losses (Nom)	77.5 W
Wiring	
Connector Type	Screw
System characteristics	
Rated Ballast-Lamp Power	2000 W

Temperature	
T-Winding (Max)	130 °C
Delta-T Normal Conditions	75/80 °C
Approval and Application	
Approval Marks	CCC certificate
Product Data	
Full product code	694818229961100
Order product name	BMH 2000L 2050
EAN/UPC - Product	6948182295439
Order code	913710107242
Numerator - Quantity Per Pack	1
Numerator - Packs per outer box	1
Material Nr. (12NC)	913710107242
Net Weight (Piece)	13.500 kg

## HID-High Power ballasts for MH lamps

### Dimensional drawing

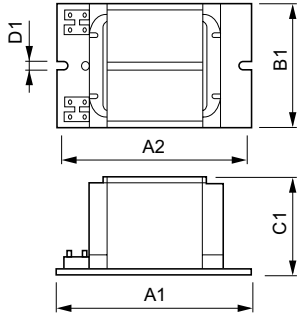

Product	D1	C1	A1	A2	B1
BMH 2000L 2050	7 mm	102.0 mm	234 mm	185.5 mm	120.0 mm

BMH 2000 L2050

