



HID-Basic ballasts for HPL and HPI(PLUS) lamps

BHL 125L 200

The HID-Basic ballast is an impregnated (HID standard) electromagnetic ballast for HID lamps, for use in combination with an external ignitor.

Product data

General Information		Temperature	
Application Code	L200	T-Winding (Max)	130 °C
Operating and Electrical		Approval and Application	
Input Voltage	220 V	Approval Marks	CE marking CCC certificate
Input Frequency	50 Hz	Product Data	
Power Factor 100% Load (Min)	0.85	Full product code	871016303168230
Mains Voltage Performance (AC)	-8%~+6%	Order product name	BHL 125L 200
Mains Voltage Safety (AC)	-10%~+10%	EAN/UPC - Product	8710163148540
Input Current with PF Correction	0.7 A	Order code	913710105050
Input Current without PF Correction	1.15 A	Numerator - Quantity Per Pack	1
Power Factor without PF Compensation (Nom)	0.55	Numerator - Packs per outer box	6
Power Losses (Nom)	12.2 W	Material Nr. (12NC)	913710105050
Wiring		Net Weight (Piece)	1.190 kg
Connector Type	Screw		
System characteristics			
Rated Ballast-Lamp Power	125 W		

HID-Basic ballasts for HPL and HPI(PLUS) lamps

Dimensional drawing

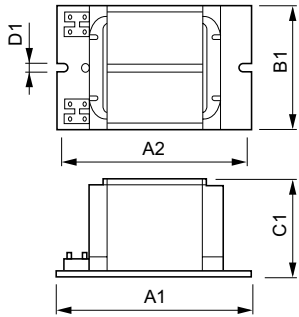

Product	D1	C1	A1	A2	B1
BHL 125L 200	6.2 mm	51.5 mm	117.0 mm	102.0 mm	57.1 mm

BHL 125 L200

