



# HID-Basic ballasts for HPL and HPI(PLUS) lamps

## BHL 400L 202

The HID-Basic ballast is an impregnated (HID standard) electromagnetic ballast for HID lamps, for use in combination with an external ignitor.

### Product data

General information	
Application Code	L202
Operating and electrical	
Input Voltage	230 V
Input Frequency	50 Hz
Power Factor 100% Load (Min)	0.6
Mains Voltage Performance (AC)	-8% - +6%
Mains Voltage Safety (AC)	-10% - +10%
Input Current with PF Correction	2.15 A
Power Factor without PF Compensation (Nom)	0.85
Power Losses (Nom)	24.4 W
Wiring	
Connector Type	Screw
System characteristics	
Rated Ballast-Lamp Power	400 W

Temperature	
T-Winding (Max)	130 °C
Delta-T Normal Conditions	75 °C
Approval and application	
Approval Marks	CE marking
Product data	
Full product code	871016303127930
Order product name	BHL 400L 202
EAN/UPC - Product	8710163148328
Order code	913710102650
Numerator - Quantity Per Pack	1
Numerator - Packs per outer box	6
Material Nr. (12NC)	913710102650
Net Weight (Piece)	2.833 kg

## HID-Basic ballasts for HPL and HPI(PLUS) lamps

### Dimensional drawing

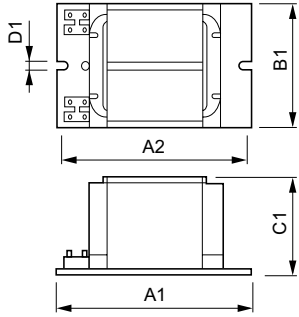

Product	D1	C1	A1	A2	B1
BHL 400L 202	6.3 mm	64.5 mm	150.0 mm	134.0 mm	75.5 mm

BHL 400L 202

