



HID-Basic ballasts for HPL and HPI(PLUS) lamps

BHL 250L 202

The HID-Basic ballast is an impregnated (HID standard) electromagnetic ballast for HID lamps, for use in combination with an external ignitor.

Product data

General information		Temperature	
Application Code	L202	T-Winding (Max)	130 °C
		Delta-T Normal Conditions	75 °C
Operating and electrical		Approval and application	
Input Voltage	230 V	Approval Marks	CE marking
Input Frequency	50 Hz		
Power Factor 100% Load (Min)	0.55	Product data	
Mains Voltage Performance (AC)	-8%~+6%	Full product code	871016303125530
Mains Voltage Safety (AC)	-10%~+10%	Order product name	BHL 250L 202
Input Current with PF Correction	1.35 A	EAN/UPC - Product	8710163148304
Input Current without PF Correction	2.13/2.15 A	Order code	913710102550
Power Factor without PF Compensation (Nom)	0.85	Numerator - Quantity Per Pack	1
Power Losses (Nom)	20.4 W	Numerator - Packs per outer box	6
Wiring		Material Nr. (12NC)	913710102550
Connector Type	Screw	Net Weight (Piece)	1.900 kg
System characteristics			
Rated Ballast-Lamp Power	250 W		

HID-Basic ballasts for HPL and HPI(PLUS) lamps

Dimensional drawing

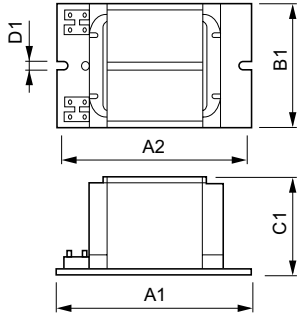

Product	D1	C1	A1	A2	B1
BHL 250L 202	6.3 mm	64.5 mm	125.0 mm	104.0 mm	72.5 mm

BHL 250L 202

