



HID-Basic ballasts for HPL and HPI(PLUS) lamps

BHL 250L 201

The HID-Basic ballast is an impregnated (HID standard) electromagnetic ballast for HID lamps, for use in combination with an external ignitor.

Product data

General Information	
Application Code	L201
Operating and Electrical	
Input Voltage	220 V
Input Frequency	60 Hz
Power Factor 100% Load (Min)	0.85
Mains Voltage Performance (AC)	-8% - +6%
Mains Voltage Safety (AC)	-10% - +10%
Input Current with PF Correction	1.35 A
Input Current without PF Correction	2.13 A
Power Factor without PF Compensation (Nom)	0.55
Power Losses (Nom)	15.5 W
Wiring	
Connector Type	Screw
System characteristics	
Rated Ballast-Lamp Power	250 W

Temperature	
T-Winding (Max)	130 °C
Delta-T Normal Conditions	65 °C
Approval and Application	
Approval Marks	CE marking
Product Data	
Full product code	871016303468300
Order product name	BHL 250L 201
EAN/UPC - Product	8710163034683
Order code	913710101816
Numerator - Quantity Per Pack	1
Numerator - Packs per outer box	6
Material Nr. (12NC)	913710101816
Net Weight (Piece)	1.900 kg

HID-Basic ballasts for HPL and HPI(PLUS) lamps

Dimensional drawing

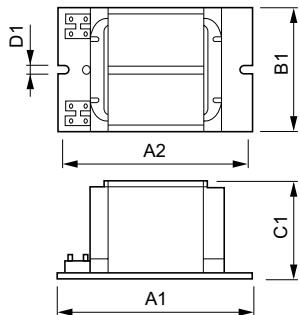

Product	D1	C1	A1	A2	B1
BHL 250L 201	6.2 mm	64.5 mm	125.0 mm	110.0 mm	75.5 mm

BHL 250 L201

