

PHILIPS

Lighting



HID-GreenVision GP-SON

HID-GVIII 600W/P GP-SON 400V

Full electronic driver for GP-SON 600/1000W lamps

Product data

General information	
Application Code	220-240V/400V
Type Version	Gen 3
Lamp Type	GP-SON
Number of Lamps	1 piece/unit
Suitable For Outdoor Use	Yes
Automatic Restart	No

Operating and electrical	
Input Voltage	400 V
Input Frequency	50 to 60 Hz
Minimum Mains Voltage Operation (Min)	368 V
Operating Frequency (Nom)	230 kHz
Power Factor 100% Load (Nom)	0.99
Ignition Voltage (Max)	2.6 kV
Ignition Voltage (Min)	2.4 kV
Ignition Switch-Off Time (Nom)	5 min
Mains Voltage Performance (AC)	-8%~+6%
Mains Voltage Safety (AC)	-10%~+10%
Output Peak Voltage (Max)	3.2 V
Inrush Current Width	1.6 ms
Inrush Current Peak (Max)	30 A

Wiring	
Cable Capacity Output Wires Mutual (Nom)	250 pF
Connector Type	JST VH Connector

System characteristics	
Rated Ballast-Lamp Power	600W/P

Temperature	
T-Ambient (Max)	40 °C
T-Ambient (Min)	0 °C
T-Storage (Max)	85 °C
T-Storage (Min)	-20 °C
T-Case Lifetime (Nom)	70 °C
T-Case Switch Off (Min)	110 °C

Controls and dimming	
Control Interface	None

Mechanical and housing	
Housing	L 181x150x58

Approval and application	
Energy Efficiency Index	A2

HID-GreenVision GP-SON

Surge Protection (Common/Differential)	EN61547 (L-L 2kV, L-G 4kV) kV
IP Classification Luminaire	65
Active Temperature Protection	Yes
EMI 9 kHz ... 300 MHz	CISPR 15 ed 7.1
Safety Standard	EN60928, 60926
Quality Standard	ISO 9000:2000
Environmental Standard	ISO 14001
Harmonic Current Emission Standard	IEC 61000-3-2
Vibration Standard	IEC 68-2-6 Fc (10-150Hz, 2G)
Bumps Standard	IEC 68-2-29 Eb (10G/16ms)
Approval Marks	CE marking ENEC certificate CB Certificate KEMA Keur certificate
Hum And Noise Level	< 45 dB(A)

Product data

Full product code	872790090905000
Order product name	HID-GVIII 600W/P GP-SON 400V
EAN/UPC - Product	8711500999511
Order code	913700660361
Numerator - Quantity Per Pack	1
Numerator - Packs per outer box	144
Material Nr. (12NC)	913700660361
Net Weight (Piece)	0.760 kg

Dimensional drawing

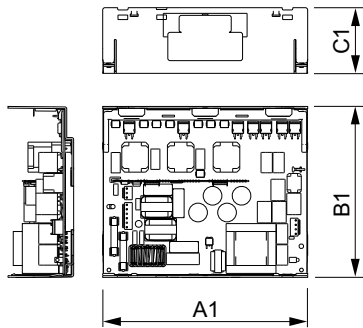

HID-GVIII 600W/P GP-SON 400V

Product	C1	A1	B1
HID-GVIII 600W/P GP-SON 400V	58 mm	181 mm	150 mm

