



# HF-Matchbox Blue

## HF-M BLUE 121 LH TL5 230-240V

HF-Matchbox Blue is an affordable, reliable, compact, lightweight and high-frequency ballast for use with system wattages below 25 W in combination with TL mini, TL-D, TL5 and TL5c, PL-T/C, and PL-L/S lamps. The HF-M Blue range has a robust design, meets all relevant international safety and performance standards and has an energy efficiency index (CELMA EEI ) of A2. The ballast is primarily designed for Indoor application. For outdoor application, the luminaire should be minimum Classland need to be sufficiently protected against water & dust. The installation should also be guard against any lightening surge or any other necessary electrical protection as deemed in such typical installation & application.

### Product data

General information	
Lamp Type	TL5
Number of Lamps	1 piece/unit
Number of Products on MCB (16A Type B) (Nom)	59
Automatic Restart	Yes
Operating and electrical	
Input Voltage	230 to 240 V
Input Frequency	50 to 60 Hz
Power Factor 100% Load (Nom)	0.64
Ignition Time (Max)	0.5 s
Mains Voltage Performance (AC)	-8%~+6%
Mains Voltage Safety (AC)	-10%~+10%
Power Losses (Nom)	2.4 W
Efficiency at full load [%]	85 %

Wiring	
Connector Type Input Terminals	Insert
Color Input Terminals	Gray
Color Output Terminals	Grey
Connector Type Output Terminals	Insert
Cable Length From Device to Lamp	1.50 m
Cable Length Hot Wiring	0.30 m
Wire Striplength	8.0-9.0 mm
Input Terminal Cross Section	0.50-1.50 mm <sup>2</sup>
Output Terminal Cross Section	0.50-1.50 mm <sup>2</sup>
System characteristics	
Rated Ballast-Lamp Power	21 W
Temperature	
T-Ambient (Max)	40 °C
T-Ambient (Min)	-10 °C

## HF-Matchbox Blue

T-Case Maximum (Max)	75 °C
<b>Mechanical and housing</b>	
Housing	LH
<b>Emergency operation</b>	
Battery Voltage Lamp Ignition	194-254 V
<b>Approval and application</b>	
IP Classification	IP20 [ Finger-protected]
Approval Marks	F-Marking CE marking VDE certificate CB Certificate

<b>Product data</b>	
Full product code	871150053646430
Order product name	HF-M BLUE 121 LH TL5 230-240V
EAN/UPC - Product	8711500536464
Order code	913700418366
Numerator - Quantity Per Pack	1
Numerator - Packs per outer box	50
Material Nr. (12NC)	913700418366
Net Weight (Piece)	0.043 kg

### Dimensional drawing

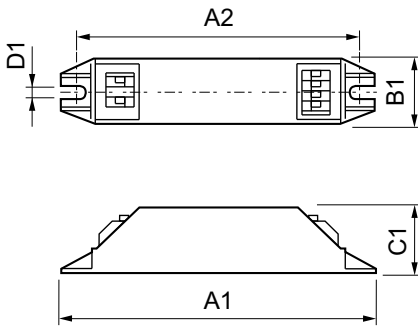

HF-M BLUE 121 LH TL5 230-240V

### Product

HF-M BLUE 121 LH TL5 230-240V

