



# EcoAccent - Enhance the Retail Experience

## EcoAccent ST271T

EcoAccent is the LED solution for shop targeting energy savings. With a system efficacy of 95 lm/W in average, delivering more than 40% energy efficient compared to CDM solution. EcoAccent helps save energy and at the same time provides excellent lighting for retail environment thus enhancing the retail experience. The option of different light distribution for Accent light and variety of lumen packs and colour temperatures makes it an ideal solution for retail lighting.

### Benefits

- Plenty of choices in form factor, lumen output and optics
- Energy saving: more than 40% energy efficient compared to CDM solution
- 1 on 1 replacement over conventional CDM light

### Features

- System efficacy up to 95 lm/W
- CRI 80
- CRI 90 optional for 3000K (CrispWhite Tech)
- High reliability 30k hours

### Application

- Office
- Shop
- Hospitality
- Healthcare
- Industrial
- Public indoor space

### Warnings and Safety

- To be used in Indoor Environment only

# EcoAccent ST271T

## Versions



## Dimensional drawing

Product: XRA TRACK MOUNTED  
 Type: ST271 T  
 Application: Indoor

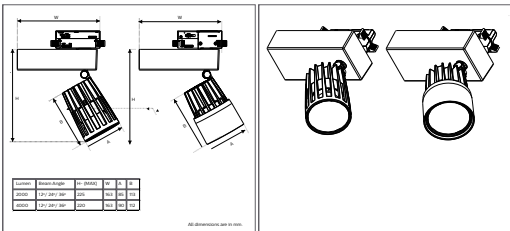

## Product

- ST271T LED20/830 PSU-E NB 1C BK
- ST271T LED20/830 PSU-E MB 1C WH
- ST271T LED20/830 PSU-E MB 1C BK
- ST271T LED20/850 PSU-E NB 1C BK
- ST271T LED20/850 PSU-E MB 1C BK
- ST271T LED20/850 PSU-E WB 1C BK
- ST271T LED20/840 PSU-E WB 1C BK
- ST271T LED20/840 PSU-E NB 1C BK
- ST271T LED40/840 PSU-E MB 1C BK
- ST271T LED20/840 PSU-E MB 1C BK
- ST271T LED40/830 PSU-E MB 1C BK
- ST271T LED40/840 PSU-E NB 1C BK
- ST271T LED40/830 PSU-E WB 1C BK
- ST271T LED40/850 PSU-E WB 1C BK
- ST271T LED40/840 PSU-E WB 1C BK
- ST271T LED40/850 PSU-E NB 1C BK
- ST271T LED40/850 PSU-E MB 1C BK
- ST271T LED20/840 PSU-E MB 1C WH
- ST271T LED40/840 PSU-E MB 1C WH
- ST271T LED40/840 PSU-E WB 1C WH
- ST271T LED40/830 PSU-E MB 1C WH
- ST271T LED40/850 PSU-E MB 1C WH
- ST271T LED20/840 PSU-E WB 1C WH
- ST271T LED20/830 PSU-E WB 1C BK

## Application conditions

Ambient temperature range	0 to +45 °C
---------------------------	-------------

## Approval and application

Mech. impact protection code	IK02
Ingress protection code	IP20

## Controls and dimming

Dimmable	No
----------	----

## Operating and electrical

Input Voltage	240 V
---------------	-------

## General information

Protection class IEC	Safety class II
Optical cover/lens type	Aluminum and polycarbonate
Driver included	Yes
Flammability mark	For mounting on normally flammable surfaces
Optic type	Beam angle 12 to 36°

## Initial performance (IEC compliant)

Init. Color Rendering Index	>80
Initial LED luminaire efficacy	100 lm/W

## General information

Order Code	Full Product Name	Beam angle of light source
919515810925	ST271T LED20/830 PSU-E NB 1C BK	12 °
919515810926	ST271T LED20/830 PSU-E MB 1C BK	24 °
919515810927	ST271T LED20/830 PSU-E WB 1C BK	36 °
919515810928	ST271T LED20/840 PSU-E NB 1C BK	12 °
919515810929	ST271T LED20/840 PSU-E MB 1C BK	24 °
919515810930	ST271T LED20/840 PSU-E WB 1C BK	36 °
919515810931	ST271T LED20/850 PSU-E NB 1C BK	12 °
919515810932	ST271T LED20/850 PSU-E MB 1C BK	24 °
919515810933	ST271T LED20/850 PSU-E WB 1C BK	36 °
919515810934	ST271T LED40/830 PSU-E NB 1C BK	12 °
919515810935	ST271T LED40/830 PSU-E MB 1C BK	24 °
919515810936	ST271T LED40/830 PSU-E WB 1C BK	36 °
919515810937	ST271T LED40/840 PSU-E NB 1C BK	12 °
919515810938	ST271T LED40/840 PSU-E MB 1C BK	24 °
919515810939	ST271T LED40/840 PSU-E WB 1C BK	36 °
919515810940	ST271T LED40/850 PSU-E NB 1C BK	12 °
919515810941	ST271T LED40/850 PSU-E MB 1C BK	24 °
919515810942	ST271T LED40/850 PSU-E WB 1C BK	36 °
919515811221	ST271T LED20/840 PSU-E MB 1C WH	24 °
919515811222	ST271T LED20/830 PSU-E MB 1C WH	24 °
919515811224	ST271T LED20/840 PSU-E WB 1C WH	36 °
919515811229	ST271T LED40/850 PSU-E MB 1C WH	24 °
919515811230	ST271T LED40/840 PSU-E MB 1C WH	24 °
919515811231	ST271T LED40/830 PSU-E MB 1C WH	24 °
919515811233	ST271T LED40/840 PSU-E WB 1C WH	36 °

## Initial performance (IEC compliant)

Order Code	Full Product Name	Init. Corr. Color Temperature	Initial luminous flux	Initial input power
919515810925	ST271T LED20/830 PSU-E NB 1C BK	3000 K	2000 lm	22 W
919515810926	ST271T LED20/830 PSU-E MB 1C BK	3000 K	2000 lm	22 W
919515810927	ST271T LED20/830 PSU-E WB 1C BK	3000 K	2000 lm	22 W
919515810928	ST271T LED20/840 PSU-E NB 1C BK	4000 K	2000 lm	22 W
919515810929	ST271T LED20/840 PSU-E MB 1C BK	4000 K	2000 lm	22 W
919515810930	ST271T LED20/840 PSU-E WB 1C BK	4000 K	2000 lm	22 W
919515810931	ST271T LED20/850 PSU-E NB 1C BK	5000 K	2000 lm	22 W
919515810932	ST271T LED20/850 PSU-E MB 1C BK	5000 K	2000 lm	22 W
919515810933	ST271T LED20/850 PSU-E WB 1C BK	5000 K	2000 lm	22 W

Order Code	Full Product Name	Init. Corr. Color Temperature	Initial luminous flux	Initial input power
919515810934	ST271T LED40/830 PSU-E NB 1C BK	3000 K	4000 lm	42 W
919515810935	ST271T LED40/830 PSU-E MB 1C BK	3000 K	4000 lm	42 W
919515810936	ST271T LED40/830 PSU-E WB 1C BK	3000 K	4000 lm	42 W
919515810937	ST271T LED40/840 PSU-E NB 1C BK	4000 K	4000 lm	42 W
919515810938	ST271T LED40/840 PSU-E MB 1C BK	4000 K	4000 lm	42 W
919515810939	ST271T LED40/840 PSU-E WB 1C BK	4000 K	4000 lm	42 W
919515810940	ST271T LED40/850 PSU-E NB 1C BK	5000 K	4000 lm	42 W
919515810941	ST271T LED40/850 PSU-E MB 1C BK	5000 K	4000 lm	42 W
919515810942	ST271T LED40/850 PSU-E WB 1C BK	5000 K	4000 lm	42 W

## EcoAccent ST271T

Order Code	Full Product Name	Init. Corr. Color Temperature	Initial luminous flux	Initial input power
919515811221	ST271T LED20/840 PSU-E MB 1C WH	4000 K	2000 lm	22 W
919515811222	ST271T LED20/830 PSU-E MB 1C WH	3000 K	2000 lm	22 W
919515811224	ST271T LED20/840 PSU-E WB 1C WH	4000 K	2000 lm	22 W
919515811229	ST271T LED40/850 PSU-E MB 1C WH	5000 K	4000 lm	42 W

Order Code	Full Product Name	Init. Corr. Color Temperature	Initial luminous flux	Initial input power
919515811230	ST271T LED40/840 PSU-E MB 1C WH	4000 K	4000 lm	42 W
919515811231	ST271T LED40/830 PSU-E MB 1C WH	3000 K	4000 lm	42 W
919515811233	ST271T LED40/840 PSU-E WB 1C WH	4000 K	4000 lm	42 W

### Mechanical and housing

Order Code	Full Product Name	Color
919515810925	ST271T LED20/830 PSU-E NB 1C BK	Black
919515810926	ST271T LED20/830 PSU-E MB 1C BK	Black
919515810927	ST271T LED20/830 PSU-E WB 1C BK	Black
919515810928	ST271T LED20/840 PSU-E NB 1C BK	Black
919515810929	ST271T LED20/840 PSU-E MB 1C BK	Black
919515810930	ST271T LED20/840 PSU-E WB 1C BK	Black
919515810931	ST271T LED20/850 PSU-E NB 1C BK	Black
919515810932	ST271T LED20/850 PSU-E MB 1C BK	Black
919515810933	ST271T LED20/850 PSU-E WB 1C BK	Black
919515810934	ST271T LED40/830 PSU-E NB 1C BK	Black
919515810935	ST271T LED40/830 PSU-E MB 1C BK	Black
919515810936	ST271T LED40/830 PSU-E WB 1C BK	Black
919515810937	ST271T LED40/840 PSU-E NB 1C BK	Black

Order Code	Full Product Name	Color
919515810938	ST271T LED40/840 PSU-E MB 1C BK	Black
919515810939	ST271T LED40/840 PSU-E WB 1C BK	Black
919515810940	ST271T LED40/850 PSU-E NB 1C BK	Black
919515810941	ST271T LED40/850 PSU-E MB 1C BK	Black
919515810942	ST271T LED40/850 PSU-E WB 1C BK	Black
919515811221	ST271T LED20/840 PSU-E MB 1C WH	White
919515811222	ST271T LED20/830 PSU-E MB 1C WH	White
919515811224	ST271T LED20/840 PSU-E WB 1C WH	White
919515811229	ST271T LED40/850 PSU-E MB 1C WH	White
919515811230	ST271T LED40/840 PSU-E MB 1C WH	White
919515811231	ST271T LED40/830 PSU-E MB 1C WH	White
919515811233	ST271T LED40/840 PSU-E WB 1C WH	White

