



Simple, robust magnetic ballast

HID-High Power ballasts for MH lamps

The HID High-Power ballast is an impregnated (HID standard) electromagnetic copper/iron ballast for use with an external ignitor for HID lamps.

Benefits

- Limited volume of ballast coil; also lightweight
- Simple installation and cabling

Features

- Orthocyclic winding process
- Ballasts equipped with screw terminal blocks as standard
- Earthing-while-mounting facility (HID Standard ballasts)
- Low watt losses

Application

- For use with MHN lamps in sports, public, area and floodlighting
- HID-Basic ballasts should be restricted to built-in situations where relative humidity is limited.

HID-High Power ballasts for MH lamps

Versions



GPPR HPMH

Dimensional drawing

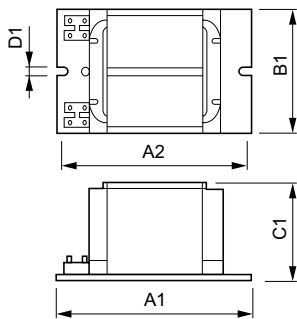

Product	D1	C1	A1	A2	B1
BMH 2000L 2050	7 mm	102.0 mm	234 mm	185.5 mm	120.0 mm
BMH 2000L 2114	7 mm	102 mm	215.0 mm	181.0 mm	117.0 mm

Operating and Electrical

Input Voltage 400 V

Operating and Electrical

Order Code	Full Product Name	Input Frequency	Line Frequency	Order Code	Full Product Name	Input Frequency	Line Frequency
913710107242	BMH 2000L 2050	50 Hz	50 Hz	913713201767	BMH 2000L 2114	-	-

