

IRT 8010/00 Point-and-Shoot Transmitter (IR)

LRH 8010/00 Wall holder



Description

- The IRT 8010/00 is a hand held two-key transmitter, suitable for the infrared remote control of lighting installations in point-and-shoot applications. The IRT 8010/00 can be used to switch and/or dim up/down a single lighting control circuits.
- N.B. Occuswitch IR can only switch the lights.
- The unit contains an integrated "teach mode" which can be used to program the Infra-Red group A-G and channel "1" addresses of the individual controllers.
- The IRT 8010/00 can also be used with WireMaster and LightMaster when the rotary switch in the battery compartment is set to position 8.

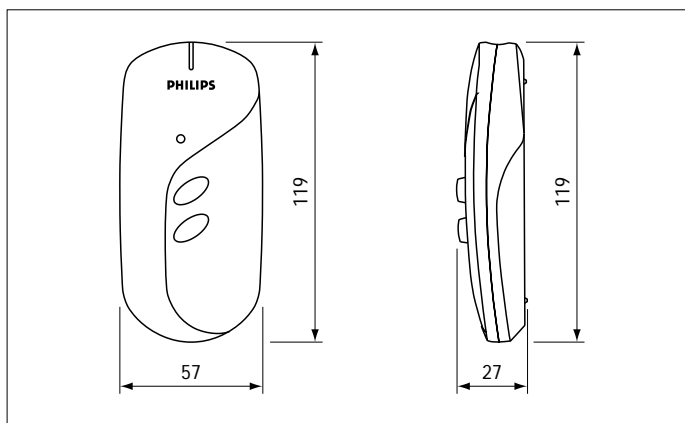

IRT 8010 transmitter

Dimensions in mm

Features

- Hand held
- Point and shoot
- Distance max. 8 m
- 2 buttons
- Red indicator LED
- Channel "1" only
- Integrated teach mode
- Rotary switch for group address A-G/general and selection of WireMaster/LightMaster functionality.
- Battery saving > 10 seconds use then auto cut off
- 2 LR03; AAA batteries included
- Battery life time with Philips Powerlife batteries - 1050 mAh (normal use) ≥ 2.5 years
- Optional: Wall holder to place next to the entrance of the room

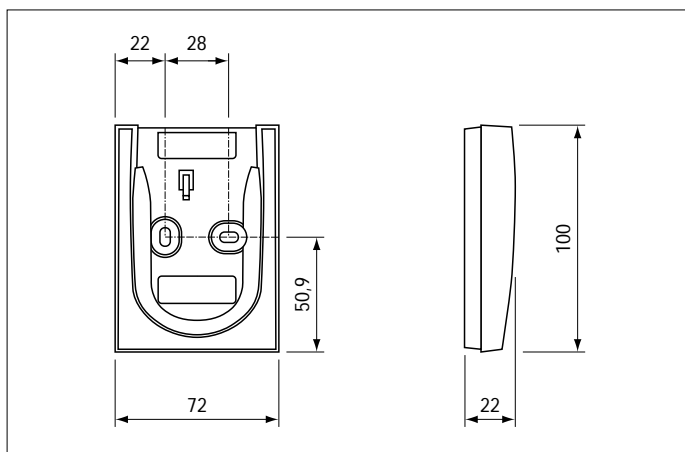

LRH 8010 wall holder

Dimensions in mm

Related equipment

- LRH 8010/00 Wall holder

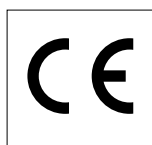

IRT 8010/00 Point-and-Shoot Transmitter (IR)

LRH 8010/00 Wall holder

Applications

- The unit is optimised for use in small control areas like standard cellular offices, small presentation rooms etc.
- The IRT 8010/00 is primarily intended for controlling the infrared versions of the "Occuswitch".
- The IRT 8010/00 is a point-and-shoot transmitter. Its main application is to override the "Presence" version of the Occuswitch or to switch (on) the "Absence" version of the Occuswitch.
- The IRT 8010/00 can also be used as a point-and-shoot transmitter in Trios, Helio, WireMaster and LightMaster applications.
- The IRT 8010/00 can also be used in combination with the IRT 8050/00 and the absence detection type of the Occuswitch. In this application the IRT 8050/00 is used as a 'wall switch', and the IRT 8010/00 provides top table remote control.
- Up to seven IRT 8010/00 transmitters (group address A-G) can be used in larger rooms together with one (or more) IRT 8050/00 transmitters at the entrances, to switch the lighting circuits individually, see figure 1.

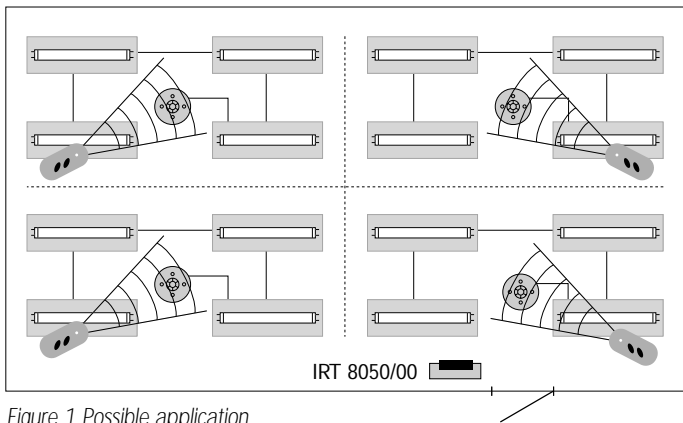

Figure 1 Possible application

Use with WireMaster and LightMaster

The IRT 8010/00 can also be used with WireMaster and LightMaster to control the lights. In this case the rotary switch in the battery compartment has to be set to position 8. Exception: when the combined head LRI 2364/10 is used the rotary switch has to be set to position 0 (see the table below and Figure 4). For WireMaster and LightMaster the two buttons of the IRT 8010/00 have the same function: the upper button can be used to switch the lights on, and also to switch them off. With LightMaster a single button can be used to switch on/off and dim.

System	Infrared receiver	IRT8010 – position of rotary switch
WireMaster 8000	IRR 8306	8
WireMaster 8000	IRR 9062	8
WireMaster 8000	IRR 9074	8
LightMaster	IRR 5362	8
LightMaster & WireMaster Plus	LRI 2364/10	0

Technical data.

Number of keys	2
Number of indicator LED's	1
Number of IR_LED's	2
Carrier frequency	36 KHz *
Protocol	RC 5 *
Battery type	LR03, AAA Power life (1050 mAh)
Number of batteries	2

* When rotary switch set to position 8 the carrier frequency and protocol are different: 20 µs pulse at 1 KHz.

Environmental conditions

Operating conditions	Operating temperature +5°C...+50°C Relative humidity 20%...85% (non condensing)
Storing conditions	Storage temperature -25 °C...+70°C Relative humidity 10%...95%

EMC

Immunity	In accordance with EN 61000-4-3
Radiated interference	In accordance with EN 61000-4-3

Mechanical specifications

Dimensions (l x w x h)	119 x 57 x 27 mm
Weight (with batteries)	78 grams
Housing material	ABS
Housing colour	RAL 9010 (White)

Reliability

Call rate:	0.2 - 0.5% per year (estimated)
Lifetime:	10 years (estimated)

Installation

Battery handling

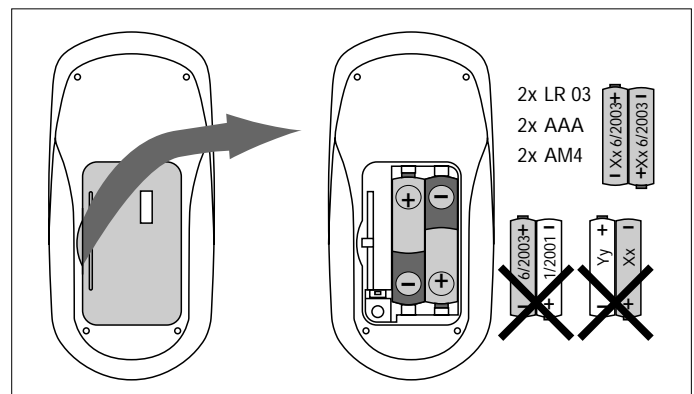

Figure 2 opening the battery compartment

In order to insert or replace the batteries, the battery compartment must be opened according to figure 2. Batteries must be replaced separately. Always use a set of 2 batteries from the same brand with the same production date. Please make sure that the batteries are inserted with the correct polarity. Inverted batteries might cause damage to the transmitter. Disposal of batteries must be in accordance to local regulations.

Positioning

The transmitter has an infrared radiation pattern as shown in figure 3. The maximum distance to the receiver is approximately 8 meters.

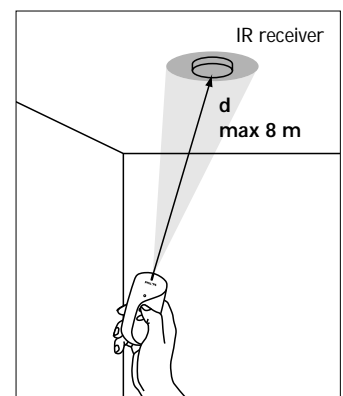

Figure 3 IR radiation

IRT 8010/00 Point-and-Shoot Transmitter (IR)

LRH 8010/00 Wall holder

Selection of infrared groups *

In order to avoid that all lighting circuits in one room are switched unintentionally, the transmitters present in one room and their respective receivers can be given a different infrared group address. The group address of the transmitter can be changed by using the rotary switch in the battery compartment, see figure 4.

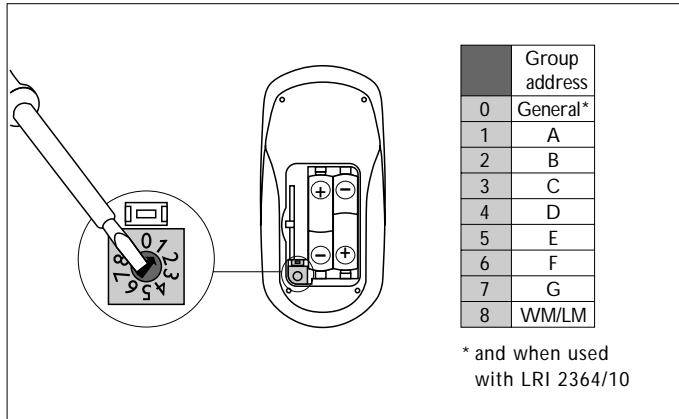

Figure 4 rotary switch

Note: teach commands are always transmitted in the "general" address code, so each controller will react regardless it's actual programmed group address. To avoid this, take care of a IR transmitter – IR receiver/controller distance of 1.5 m.

Teaching of infrared groups *

In order to adjust the group address of the controller to that of the corresponding transmitter, the next procedure should be followed:

1. Set the rotary switch in the desired group address position, see figure 4.
2. Bring the IRT 8010/00 into the teach mode by pressing the teach mode button for more than two seconds, see figure 5. The red LED will blink.
3. Press button 1 followed by button 0.
4. Bring the IRT 8010/00 back into normal operation:
 - press the teach mode button for (0.5 seconds),
 - or
 - automatically when no buttons are pressed during 15 seconds,
 - or
 - turn the rotary switch.

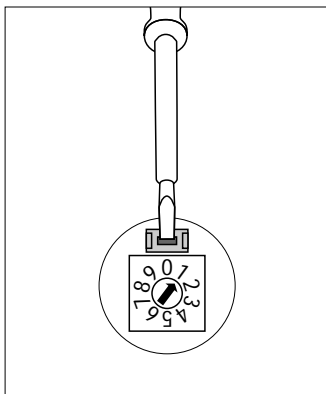

Figure 5 teach mode button

Teaching the Occuswitch

In order to teach the "Presence" or "Absence" mode of the Occuswitch, the next procedure should be followed:

1. Set the rotary switch in the group address position "general" (=0).
2. Bring the IRT 8010/00 into the teach mode by pressing the teach mode button for more than two seconds, see figure 5. The red LED will blink.
3. Press button 1 for "Presence" mode or button 0 for "Absence" mode.
4. Bring the IRT 8010/00 back into normal operation:
 - press the teach mode button for (0.5 seconds),
 - or
 - automatically when no buttons are pressed during 15 seconds,
 - or
 - turn the rotary switch.

Mounting

The IRT 8010/00 can be stored in the separately available wall holder, see figure 6.

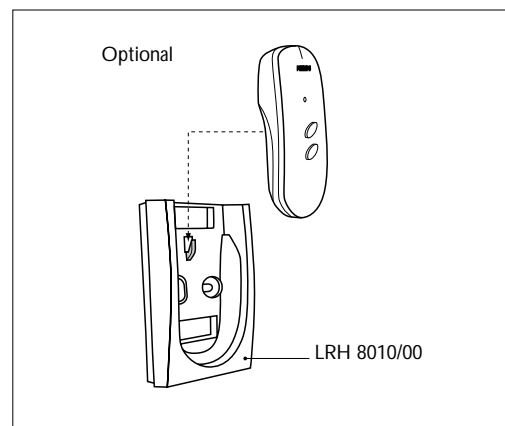

Figure 6 LRH 8010 wall holder

Red indicator LED

Transmission of infrared signals is indicated by a red LED. In teach mode the red LED is blinking 0.5 sec on and 0.5 sec off, see figure 7.

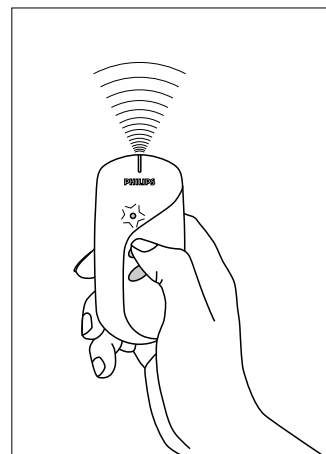

Figure 7 indicator LED

* Not for use with WireMaster and LightMaster.

IRT 8010/00 Point-and-Shoot Transmitter (IR) LRH 8010/00 Wall holder

3222 636 30312
12/2001
Printed in EU
Data subject to change

<http://www.controls4lighting.com>

Packing data

Transmitter

Type	Box dimensions (mm)	Qty	Material	Weight (kg) net	gross
Unit box	131 x 58 x 87	1	card board	0.06	0.097
Outer box	240 x 135 x 87	12	card board	1.20	1.270

Wall holder

Type	Box dimensions (mm)	Qty	Material	Weight (kg) net	gross
Unit bag		1	plastic	0.034	0.04
Outer box	240 x 135 x 87	12	card board	0.5	0.57

Ordering data

Type	MOQ	Ordering number	EAN code level 1	EAN code level 3
IRT 8010/00	12	9137 003 14203	87 11559 517 490	87 11559
LRH 8010/00	12	9137 003 16303	87 11559 517 971	517 711